

# EPML-Q

## Product Pictures



## Application

- EPML-Q series is suitable for lifting small steel billets, moulds, steel sheet and etc.
- Several pcs of EPML-Q could be united with a beam to lifting long steel..

## The Brief Drawing

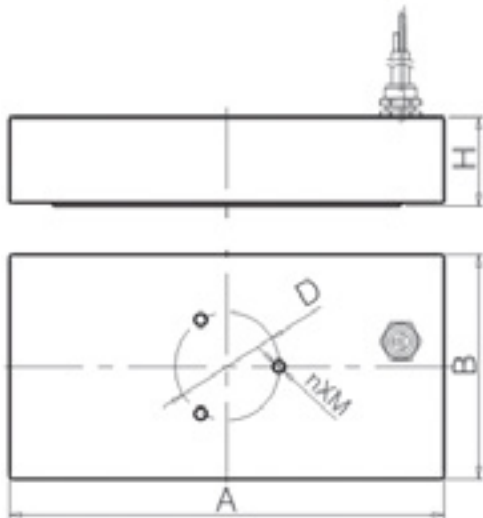

## Features

- Lifting force:  $12\text{kg}/\text{cm}^2$ ;
- 3.0 times the safety factor;
- Different pole shoes could be choose according to shap and dimensions of workpiece.
- Electrical power is only required when cycling from Magnetization to Demagnetization.
- Cycle time is 1~3 seconds depending on the size of the system.
- No heat is generated since the power is not constantly applied.
- Variable magnetic power for the handling of thin sheets of steel.



- V-shaped pole shoes for round steel



- Half V-shaped pole shoes for feedstock