

RMM series

Product Pictures



Description

- Powerful round permanent magnetic chuck

Application

- For heavy cutting and carbon alloy process
- Suitable for workpieces that are difficult to clamp

The Brief Drawing

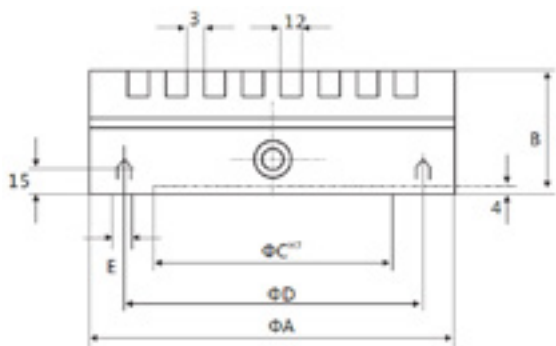

Features

- Extremely Strong holding force combined with slim construction
- With coolant and water proof structure
- Can be switched ON or OFF by hand lever
- Nominal holding force: 150 N/cm²
- Magnetic field depth: 10mm
- Pole plate wearing limit: 5mm
- Pole pitch: steel 12mm, brass 3mm
- Pole pitch 4+15 mm can be produced
- Center hole and concentric rings could be machined for positional guide.

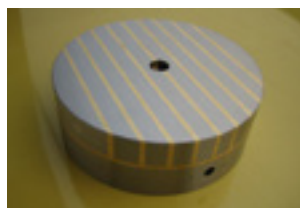

SPECIFICATIONS

MODEL	DIMENSIONS (MM)					WEIGHT (KG)	POLE PITCH (MM)
	A	B	C	D	E		
RMM100	100	56	70	91	3xM5	3.5	3+12
RMM160	160	56	125	142	4xM8	9	3+12
RMM200	200	56	150	182	4xM8	14	3+12
RMM250	250	56	200	232	4xM8	22	3+12
RMM300	300	56	250	285	4xM8	31	3+12
RMM350	350	56	300	334	4xM8	43	3+12
RMM400	400	61	300	350	6xM10	60	3+12

Other size on request